

MARCH SPECIALS

2024

CATTLE FORCE YARD BLIND

- 3 Piece Curved Panels
- Sheeted to be animal friendly
- Designed to improve speed of stock flow
- Swing gate has spring control latch
- Innovative braking system that stops the cattle from pushing back



NEW

\$6,140 Inc Gst

HEAVY DUTY CATTLE RAMP

- 4000mm Ramp with 2050mm Level Extension for easy loading
- Loading height 1200mm
- Two operator side access gates
- 50mm Treated Pine Flooring
- Non Slip Side Walkway with HandRail
- Truck bumper bollards
- Rear sliding gate



NEW



\$12,300 Inc Gst

300 HEAD SHEEP YARD

- Heavy duty 60x30 sheep panels
- Blind panels included • 3 way Adjustable Race (Aus made)
- Adjustable Sheep Loading Ramp (Aus made)
- All fully galvanised
- Installation Available

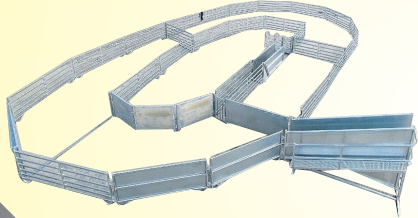

\$13,500*

50-100 HEAD SHEEP YARD

- Heavy Duty 60x30 Sheep panels
- Blind panels included
- 3 way Adjustable Race (Aus made)
- Adjustable Sheep Loading Ramp (Aus made)
- All fully galvanised
- Installation Available

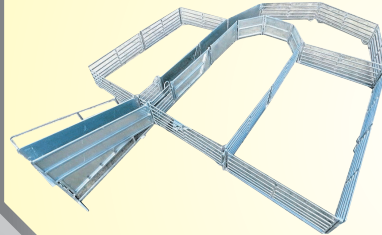

\$9,600*

BUDGET SHEEP GOAT PANEL

- 2900 Long x 1150 High
- 7 Rail 250D Galvanized
- With Pins

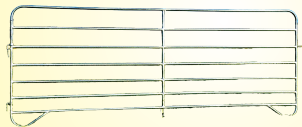

Crazy Price

\$96 each

15M HORSE ROUND YARD KIT

- KIT INCLUDES**
- 21 - 2100 X 1800 40-OD Gal Panels
 - 1 - Ride Through Gate in Frame
 - 44 - Joining Pins



Crazy Price

\$2,308 Inc Gst

HEAVY DUTY SHEEP PANEL

- 1100 X 2900
- 60 X 30 Rail
- 6 Rail
- With Pins

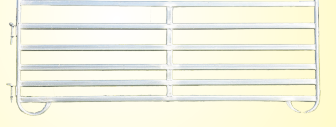

\$139 each

CATTLE LOADING RAMPS

- Fixed Ramp = Mesh Floor
- Adjustable Ramp = Wood Floor
- All Galvanized Construction



Non Adj
\$2,365
Adj
\$3,120



CATTLE CRUSH

- Budget \$4,230
- Economy \$5,260
- Vet \$5,960



HORSE/CATTLE BUDGET PANEL

- 6 Rail 40-OD
- 2100 W x 1800 H
- Fully Galvanized
- Pins Included

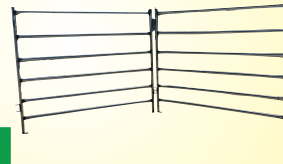

\$96 each

COMBO SHEEP/CATTLE PANEL

- 7 Rail
- 2100 W x 1800 H
- 60/30 Oval Rail
- Galvanized
- SHEEP ✓**
- CATTLE ✓**



\$125 each

BUDGET CATTLE/HORSE PANELS

- 2100 Wide x 1650 High
- Galvanized • 5 Rail 60 x 30 Oval Rail



\$96 each

PREMIUM 60X30 RAIL

- 2100 Wide x 1800 High
- Galvanized • 6 Rail 60 x 30 Oval Rail

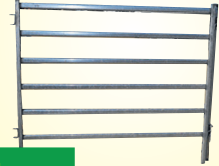

\$111 each

PREMIUM HEAVY 80X40 RAIL

- 2100 Wide x 1800 High
- Galvanized • 6 Rail 80 x 40 Oval Rail

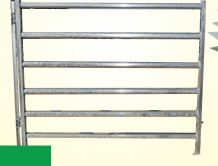

\$126 each

BULL PANEL 115X42 RAIL

- 2100 Wide x 1800 High
- Galvanized • 5 Rail 115 x 42 Oval Rail



\$143 Inc Gst

ADJUSTABLE SHEEP LOADING RAMP

- Fully Galvanized • 3.15m Long x 600mm Wide (Internal) • Walkway & Handrail • Fully Sheeted Sides



\$2,365 each

3-WAY ADJUSTABLE SHEEP RACE

- Adjustable Sides
- Fully Galvanized • Australian Made

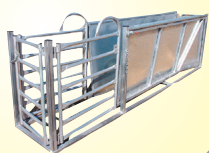

\$2,550

RAISED SQUARE BALE FEEDER CRADLE

- Fully galvanised
- Heavy duty
- Rubber tray to catch feed
- Australian made



\$1,940*

BALE FEEDER WITH ROOF

- Smooth sliding easy to operate
- Lugs to pin into ground



NEW



\$2,420 Inc Gst

SQUARE BALE FEEDER

- 5ft X 9ft • To Suit 8ft X 4ft square bales
- Heavy Duty. Made from 33 OD Pipe & Sheeted
- Fully Galvanized



\$780 each

ROUND BALE FEEDER

- 5ft Diameter • To suit Round Bales
- Heavy Duty. Made from 33 OD Pipe Sheeted
- Fully Galvanized



\$600 each

SUPPLEMENT FEEDER

- 2.4m long • 400mm tray
- Folding lid

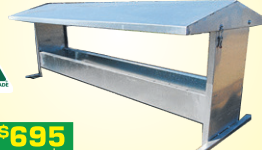

\$695 each

ROUND BALE CRADLE FEEDER

- Fully Galvanized • Heavy duty construction
- Australian made • Suits round bales

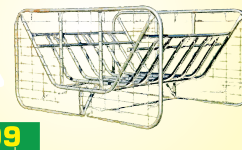

\$899 each

SQUARE BALE CRADLE FEEDER

- Fully Galvanized • Heavy Duty Construction
- Australian Made • Suits Big Square Bales



\$899 each

steel supplies

No Flies on Steel Supplies!



* all prices are quoted inclusive of GST

Bomen

Lavington

Wodonga

23 Bomen Rd, Bomen NSW 2650 • Ph: 02 6921 9119 • E: sales@steelsuppliesbomen.com.au

364-366 Urana Rd, Lavington NSW 2641 • Ph: 02 6040 2000 • E: saleslbury@steelsuppliesaw.com.au

13 Hovell St, Wodonga VIC 3690 • Ph: 02 6024 4000 • E: saleswodonga@steelsuppliesaw.com.au